

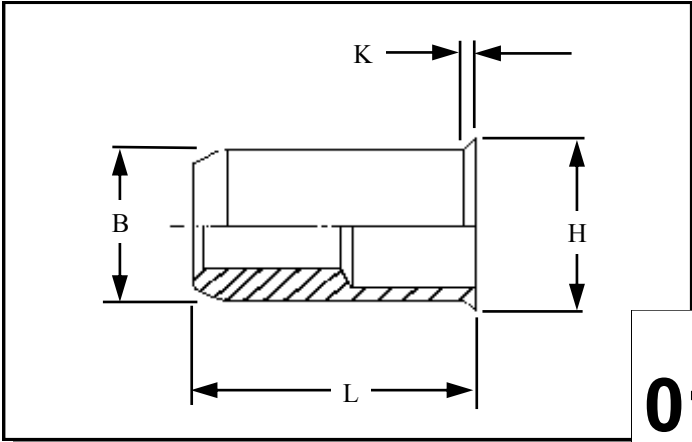

RIVETNUT TECHNOLOGY SYSTEMS LIMITED

RLOI IN STAINLESS STEEL



Round low profile head open ended Rivetnuts for material up to 9.20 mm thick

All dimensions in mm
Material :- Stainless Steel (AISI 303)
Finish :- Self colour

R.T.S. SALES LINE
01296 330331

TECHNICAL DATA SHEET

THREAD SIZE	GRIP RANGE	HOLE SIZE A/F -0.0 +0.10	BODY A/F "B"	HEAD DIA "H" ± 0.10	LENGTH "L"	"K"	PART NUMBER
M3	0.50 to 1.10 1.00 to 2.30 2.00 to 3.20 3.20 to 4.10	5.10	5.00	5.80	6.70 7.90 9.10 10.00	0.30	RLOI-03011 RLOI-03023 RLOI-03032 RLOI-03041
M4	0.50 to 1.30 1.00 to 3.00 3.00 to 4.20 4.20 to 5.50	6.10	6.00	6.80	8.40 9.90 11.30 12.60	0.30	RLOI-04013 RLOI-04030 RLOI-04042 RLOI-04055
M5	0.50 to 1.50 0.50 to 2.50 1.00 to 3.50 3.00 to 4.50	7.10	7.00	8.00	9.60 10.60 12.90 12.60	0.40	RLOI-05015 RLOI-05025 RLOI-05035 RLOI-05045
M6	0.50 to 1.50 1.00 to 3.50 2.00 to 4.50 3.00 to 5.50 4.50 to 6.50	9.10	9.00	10.00	11.90 13.90 14.90 15.90 16.80	0.40	RLOI-06015 RLOI-06035 RLOI-06045 RLOI-06055 RLOI-06065
M8	0.50 to 1.80 0.50 to 3.00 1.80 to 4.20 2.50 to 5.00 4.50 to 6.50	11.10	11.00	12.00	14.40 15.60 16.80 17.60 19.10	0.40	RLOI-08018 RLOI-08030 RLOI-08042 RLOI-08050 RLOI-08065
M10	0.50 to 3.20 2.50 to 5.50 3.50 to 6.50 5.50 to 7.50	13.10	13.00	14.50	19.10 21.40 22.40 23.40	0.60	RLOI-10032 RLOI-10055 RLOI-10065 RLOI-10075
M12	0.50 to 4.20 2.50 to 6.00 4.00 to 7.60 7.00 to 9.20	16.10	16.00	17.50	23.00 24.40 26.00 27.60	0.60	RLOI-12042 RLOI-12060 RLOI-12076 RLOI-12092

For additional information and technical support please contact R.T.S. technical sales department . R.T.S. reserve the right to change specifications at any time . Information given is for guidance only and should not be used for specific design criteria without reference to our application engineers.