

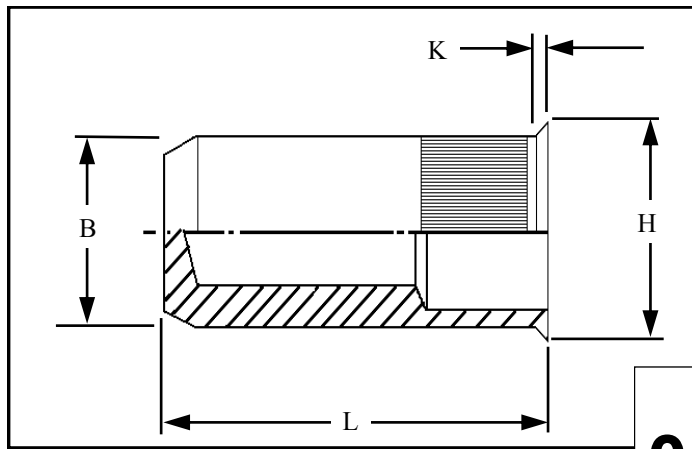

RIVETNUT TECHNOLOGY SYSTEMS LIMITED

KLCI IN STAINLESS STEEL

Knurled Round low profile head
closed ended Rivetnuts for
material up to 9.20 mm thick



All dimensions in mm
Material :- Stainless steel (AISI 303)
Finish :- self colour

R.T.S. SALES LINE

01296 330331

TECHNICAL DATA SHEET

THREAD SIZE	GRIP RANGE	HOLE SIZE -0.0 +0.10	BODY DIA "B"	HEAD DIA "H" ± 0.10	LENGTH "L"	"K"	PART NUMBER
M3	0.50 to 1.10 1.00 to 2.30 2.30 to 3.20 3.20 to 4.10	5.10	5.00	5.80	10.70 11.80 13.10 14.00	0.30	KLCI-03011 KLCI-03023 KLCI-03032 KLCI-03041
M4	0.50 to 1.30 1.80 to 3.00 3.00 to 4.20 4.20 to 5.50	6.10	6.00	6.80	14.40 15.90 17.00 18.30	0.30	KLCI-04013 KLCI-04030 KLCI-04042 KLCI-04055
M5	0.05 to 1.50 0.50 to 2.50 1.50 to 3.50 3.00 to 4.50	7.10	7.00	8.00	16.50 17.40 18.50 19.50	0.40	KLCI-05015 KLCI-05025 KLCI-05035 KLCI-05045
M6	0.50 to 1.50 1.50 to 3.50 2.50 to 4.50 3.50 to 5.50 5.00 to 6.50	9.10	9.00	10.00	19.90 21.90 22.90 23.90 24.90	0.40	KLCI-06015 KLCI-06035 KLCI-06045 KLCI-06055 KLCI-06055
M8	0.50 to 1.80 1.00 to 3.00 2.20 to 4.20 3.00 to 5.00 4.50 to 6.50	11.10	11.00	12.00	23.60 24.80 26.00 26.80 28.30	0.40	KLCI-08018 KLCI-08030 KLCI-08042 KLCI-08050 KLCI-08065
M10	0.50 to 3.20 3.50 to 5.50 3.50 to 6.50 5.50 to 7.50	13.10	13.00	14.40	30.90 33.40 34.40 35.40	0.50	KLCI-10032 KLCI-10055 KLCI-10065 KLCI-10075
M12	0.00 to 4.20 2.50 to 6.00 4.00 to 7.60 7.00 to 9.20	16.10	16.00	17.40	36.00 36.30 38.30 39.60	0.50	KLCI-12042 KLCI-12060 KLCI-12076 KLCI-12092

For additional information and technical support please contact R.T.S. technical sales department . R.T.S. reserve the right to change specifications at any time . Information given is for guidance only and should not be used for specific design criteria without reference to our application engineers.